

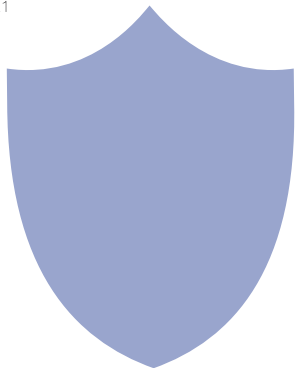

HD 1080P Wireless Security Wi-Fi Camera

User Manual
Version: :April, 2021



5. Press  icon on the right corner of camera --> WiFi Config -->Select local Wi-Fi (SSID) --> Input password --> Tap Next;
 - 6.Quit APP , wait 30 seconds (device restart automatically)and connected with set Wi-Fi(Wi-Fi indicator is solid);
 - 7.Enter APP to check live video locally or remotely anywhere.
- P.S.: Contact local dealer for tutorial video setting up.

3

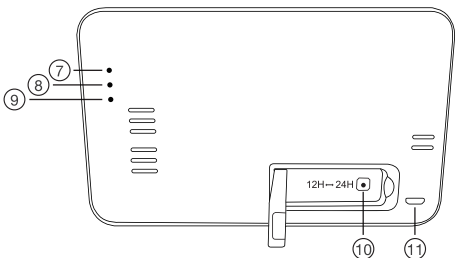

- | | |
|-------------------------|---|
| ① Camera | ⑦ Charging indicator |
| ② 5 inch display screen | ⑧ Wi-Fi indicator |
| ③ Reset key | ⑨ Power indicator |
| ④ ON/OFF key | ⑩ 12H/24H: Long press to turn on/off screen display |
| ⑤ Micro SD card slot | ⑪ USB port |
| ⑥ Night vision lights | |

Tips: The time and temperature will be updated automatically every 2 hours after Wi-Fi connection.

7



Size: 48x48x48mm



AC Charger (no battery)



Overview:

These wireless Wi-Fi security camera comes with HD 1080P high resolution camera for live video streaming worldwide from anywhere by smartphone APP TinyCam Pro;

The AC Charger is plug and play, and with a functional USB output (600mA); It also equipped with 16pcs invisible leds for around 4 meters night vision. And the Weather Forecast Clock works with powerful invisible 6M night vision for day and night.

Usages: Nanny camera, Home/ Shop/ Office/ Warehouse surveillance camera.....

Warning : " illegal use is not allowed! Or, there will be consequences to bear! "

In the box:

AC Charger:
1 x Camera Unit
1 x User Manual
1 x Reset Pin
1 x Micro SD Card Reader

Weather Clock:
1 x Camera Unit
1 x User Manual
1 x USB Cable
1 x Micro SD Card Reader
1 x 5V2A Power Adapter

4

Wi-Fi Camera Connection Setting

Step1: Download and install APP

Scan below QR code or search and download free APP named <TinyCam Pro> in Apple APP store, Google play or Electronic market, and install it;

Tips: Please allow "TinyCam Pro" to access your location while you are using the app(for syncing local weather info).



8



Size: 145x16x87mm



Weather Clock

1

Product structure of AC Charger

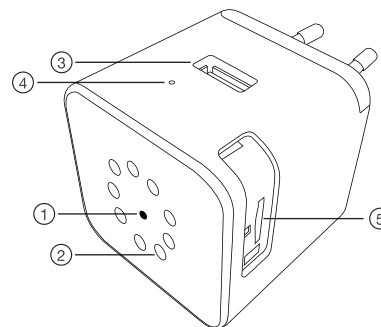

- | | | |
|--------------------------------|----------------------|------------|
| ① Camera | ② Night vision leds | ③ USB port |
| ④ Reset hole / Power indicator | ⑤ Micro SD card slot | |

5

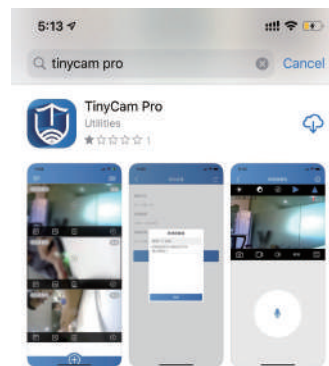

Step 2: Insert micro SD card -->Plug in devices with power --> wait for 1 minute(Power indicator and Wi-Fi indicator is flashing regularly.);

9

Quick guide of Wi-Fi camera function:

- 1.Download Free App <TinyCam Pro> from App Store or Google Play.
Tips:Please allow "TinyCam Pro" to access smartphone location while using the APP.
- 2.Insert micro SD card --> Plug in Power adapter, wait for 1 minute (Power indicator and Wi-Fi indicator is flashing regularly);
3. Enter smartphone settings --> Search and connect device's Wi-Fi named: AIS.....,wait till phone status bar appear Wi-Fi symbol  ;
4. Enter APP, tap below "⊕" icon --> LAN search-->Tap the found device --> Tap Add --> Camera Online then;
Tips:This step = P2P mode, can check video locally when without Wi-Fi.

2

Product structure of Weather Clock:

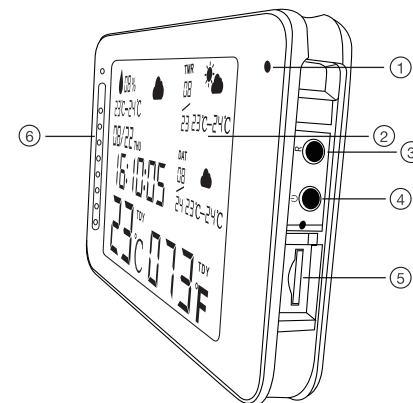

6

Step 3:Connect Wi-Fi

1.Open smartphone settings, search and connect the device's wireless signal named"AIS.....",wait Wi-Fi connected, and phone status bar appear Wi-Fi symbol.

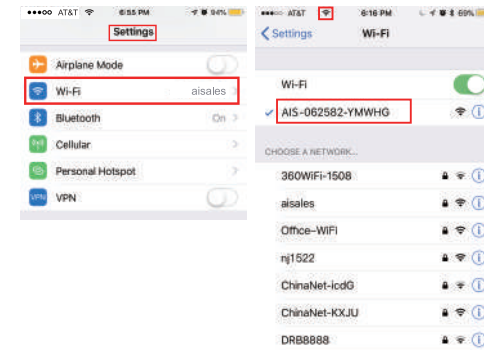

10

2. Enter APP, tap below “+” icon --> LAN search-->Tap the found device --> Tap Add --> Camera Online then;

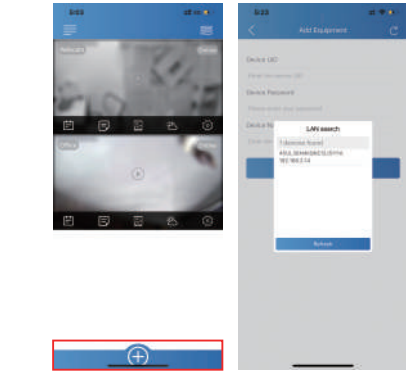

Tips : This step = P2P mode, can check video locally when without Wi-Fi.

11

APP introduction:

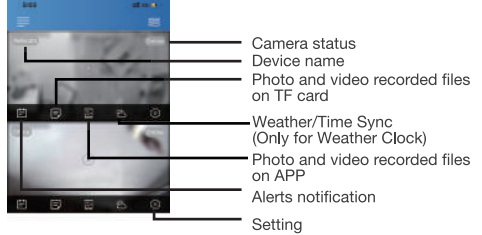

Tips: 1. Please confirm phone setting has allowed TinyCam Pro App to access the location services;
2. A TF card(Micro SD card) must be inserted for saving alerts pictures.

15

Weather Clock Specification

Resolution	1 Mega CMOS
Video pixel in phone	Max 1920*1080
Video pixel in card	1080*720
Frames	Max 25fps
Compressed format	H.264
View angle	120 Degree
Type of memory card	TF card>=Class 4/10 and HC marked
Maximum capacity of memory card	128GB
PC operation system	Windows 7, 8 / Mac OS X
Play software	VLCPPlayer/SMPlayer
Mobile phone operation system	Android/iOS
Web browser	IE7 and above,chrome,firefox
Power consumption	300MA/3.7V
Battery Capacity	Rechargeable 1800 mA
Recording	1 minute/ around 20MB
Working time in day time	Around 4-5 hours
Working time in night time	Around 2-3 hours
Charging time	3-4 hours
Power adapter	5V / 2A

19

3.Tap icon on the right corner of camera --> Wi-Fi Config--> Select local Wi-Fi (SSID) --> Input password --> Tap Next;

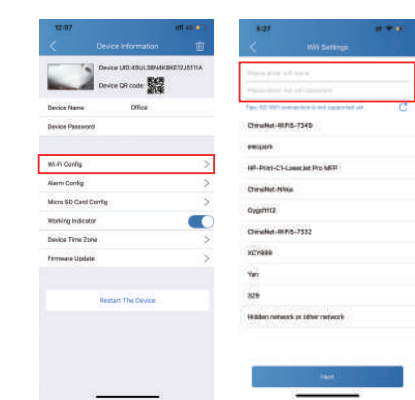

12

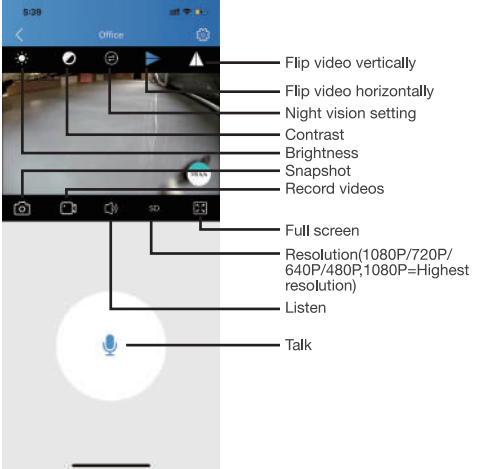

16

FAQ

- 1.Q: Time display is not stable, always blinking?
A: It's with low battery, please charge it.
2. Q: Can't get device Wi-Fi signal?
A:Press reset key for 10 seconds and wait 1 minute.
3. Q: Live video not smooth and clear?
A: Select suitable resolution according to the real time network environment.
4. Q: Motion detect set and alarm?
A: 1). Set motion detect sensitivity in App Setting > Alarm Config;
2). When motion detected, camera will push a alarm message to your phone and take one picture for checking in the APP [Page 15 - Alert notification]. (A micro sd card MUST be inserted for saving alarm pictures)

20

4.Quit APP , wait 30 seconds (device restart automatically)and connected with set Wi-Fi(Wi-Fi indicator is solid) ;
5.Enter APP and check live video locally or remotely anywhere.



13

- ① Share camera with others by QR code
- ② Wi-Fi Config: Set camera to connect to local Wi-Fi
- ③ Alarm Config: Set motion detection sensitivity
- ④ Micro SD Card Record Config: Set SD card recordmode / Resolution /File length...
- ⑤ Working Indicator: To turn on/off device's working led
- ⑥ Firmware Update: Update device's latest firmware by app

5. Q: Micro SD card instruction?
A: 1). Set motion detect sensitivity in App Setting > Alarm Config;
2). Once device is connected to Wi-Fi, can set SD management in App Setting > Micro SD Card Config.
6. Q: How to play micro SD card video?
A: 1). Use a card reader to read and play;
2). Use APP to play back [Page 15 - TF card recorded files];
3). Play back in good speed network.
7. Q: Forget camera password, or item goes abnormal?
A: Turn on camera and wait for 1 minute, press reset key around 10 seconds till back indicators off to restore factory default. Camera restarts and get ready again in 1 minute.
8. Q: Any operation video demo of the camera for setting up?
A: Please contact local dealer for video guide.

21

Set camera name and private code

Set name:Tap the icon after the camera, Input a new name(like Office ...) in Device Name;
Set new password: Tap the icon after the camera, Tap Device Password --> Old password = 888888.

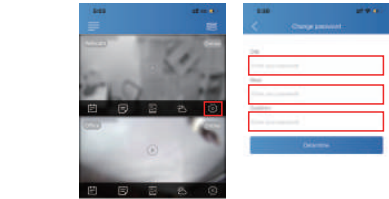

14

AC Charger Specification

Resolution	1 Mega CMOS
Video pixel in phone	Max 1920*1080
Video pixel in card	1080*720
Frames	Max 25fps
Compressed format	H.264
View angle	120 Degree
Type of memory card	TF card>=Class 4/10 and HC marked
Maximum capacity of memory card	128GB
PC operation system	Windows 7, 8 / Mac OS X
Play software	VLCPPlayer/SMPlayer
Mobile phone operation system	Android/iOS
Web browser	IE7 and above,chrome,firefox
Power consumption	300MA/3.7V
Recording	1 minute/ around 20MB

18

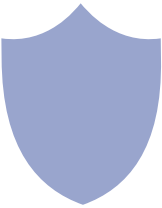

The end!